

Valve body DN 65 to 150

Seats (08), body seals (14), ball (09) replacement (Fig 5 & Fig 7)

1. Unscrew nuts (17) and boltings (13)
2. Take out valve body. Ball must be in open position
3. Operate a 90° turn in order for the ball (09) to be in the closed position
4. Push the ball (09) out of the valve body. Seat supports (20) are also pushed out
5. Take the seats (08) out of the seat supports (20)
6. Take body seals out (14)
7. Replace damage components
8. Re assemble all parts following opposite disassembly instructions
When re assembling the seats (08) and seat support (20), make sure it is done as per shown on figure 7

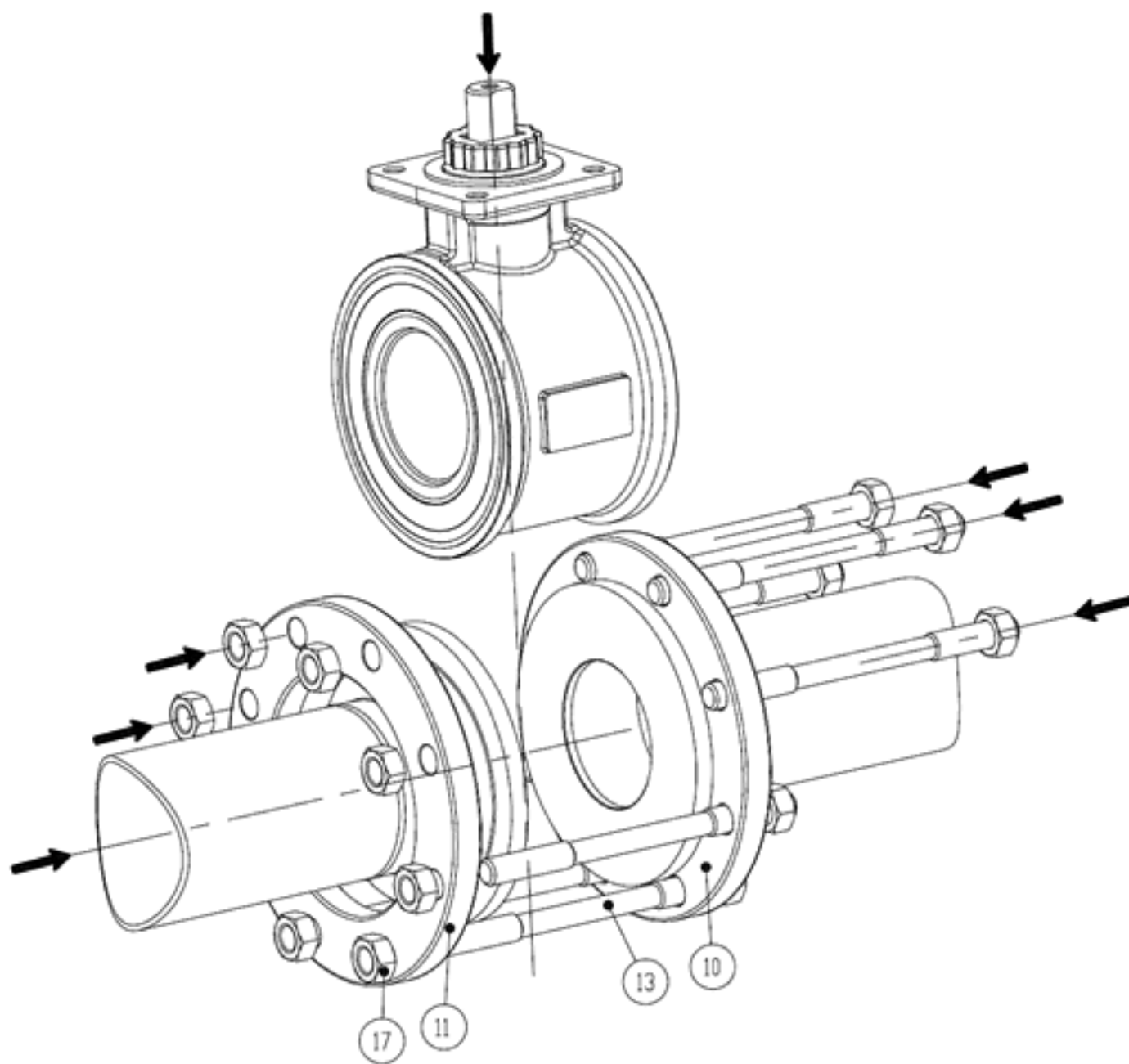

Fig 5

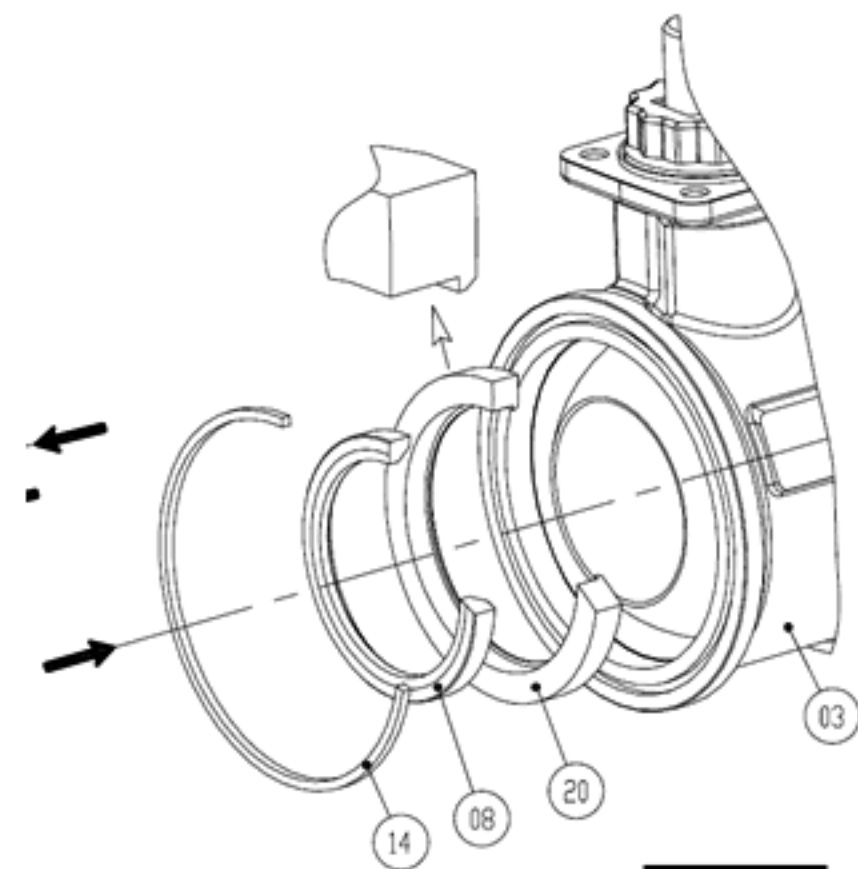

Fig 7

Packing (06) and stem seal (04) replacement (Fig 5, Fig 7 & Fig 8)

1. Unscrew one screw (13) and take it out with the spacer (12) and the nut (17) to allow valve body to be taken out
2. Take out valve body. Ball must be in the open position
3. Operate 90° to allow the ball (09) to be in the close position
4. Push the ball (09) outside of the body.
Seats (08) will be pushed as well
5. Take out Nut lock (28) and unscrew the nut (18)
6. Take spring washers (07) and gland (24)
7. Push the stem (05) inside the valve
the stem seal keep staying on the stem
8. Take out stem (05) and replace stem seal (04)
9. Take out packing (06) from valve body and replace with a new one
10. Re assemble following opposite disassembly instructions
11. Screw packing nut (18) following torques values mentioned in here after table. Do not forget to refit nut stop (28)

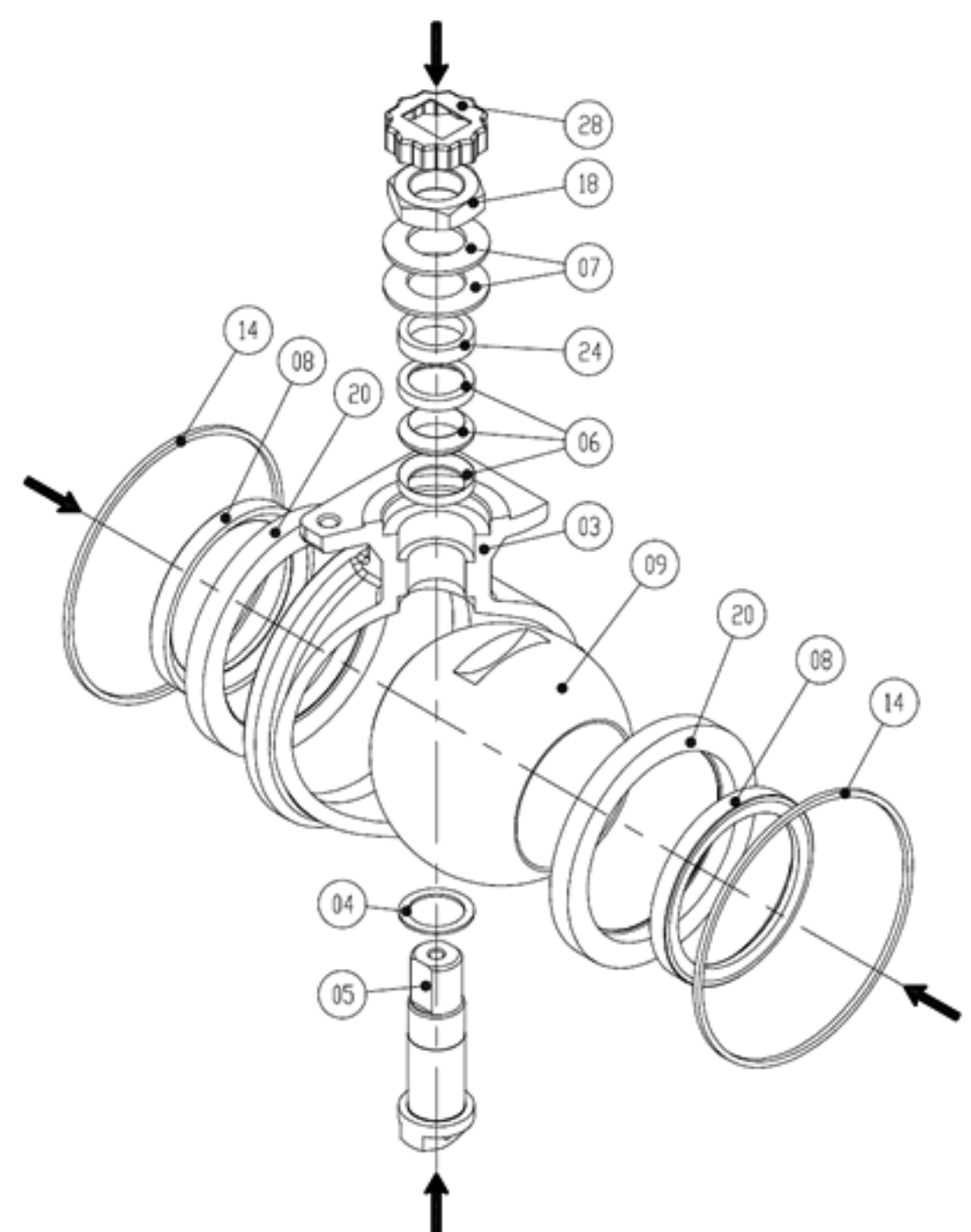

Fig 8

Size	N	65	80	100	125	150
	V		80	100	125	150
Torque Nm		35	35	35	50	50