

Valve assembly body DN 10 to 50 (Fig 4)

Size	N	8	12	15	20	25	32	40	50
	V		15	20	25	32	40	50	65
Torque Nm			10	10	22	22	40	40	60

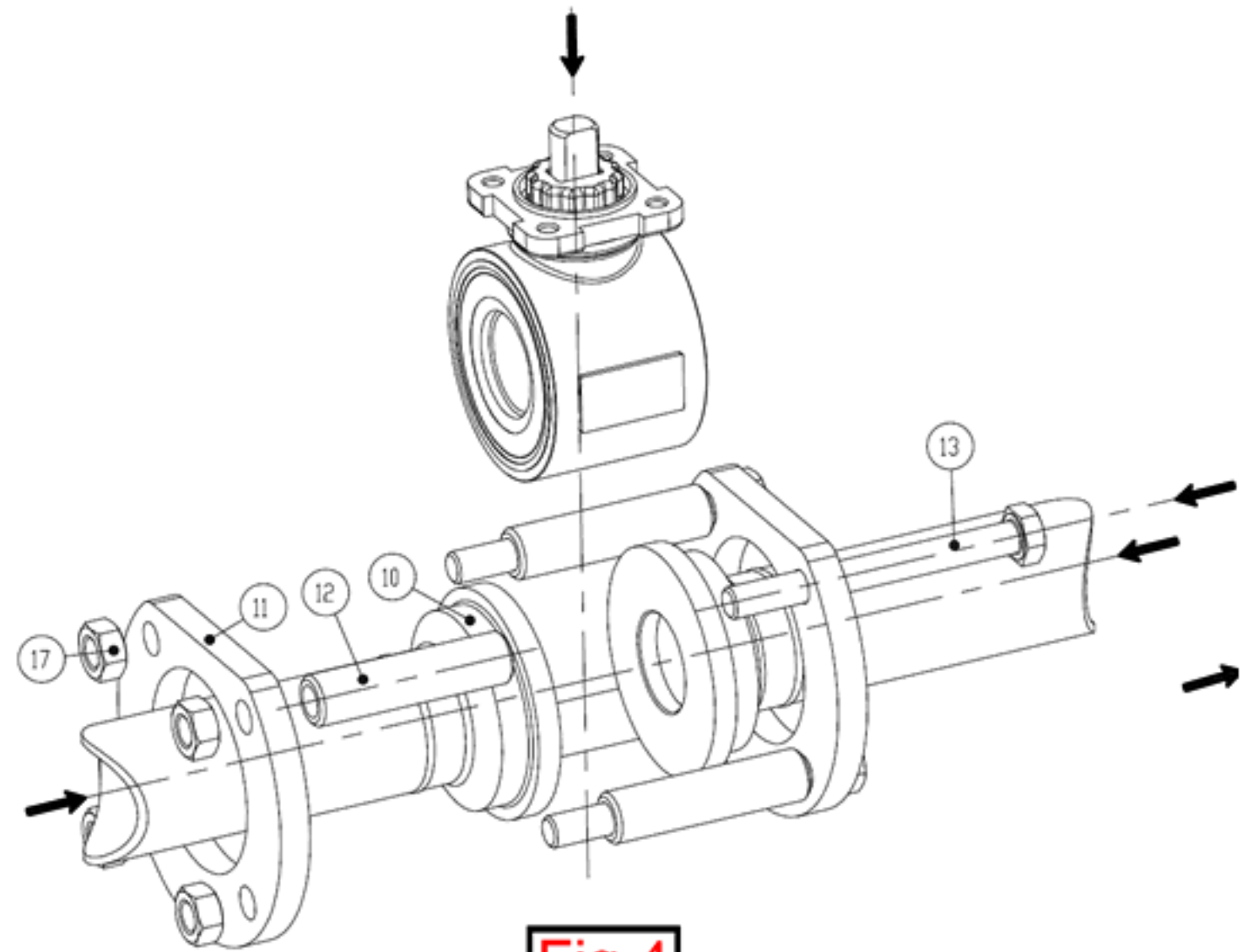

Fig 4

1. Insert body flanges (11) into the pipe
2. Weld the ends (10) on pipe
3. Insert screws (13), spacers (12) and nuts in the body flanges (11)
ONLY insert 3 in order to further allow valve body positioning
4. Insert valve body between ends (ball should be in the open position)
5. Put on the 4th screw (13), spacer (12) and nut (17)
6. Orientate the valve body as required around the pipe and tighten screws (13) and nuts (17) according to the following torque values

Valve assembly body DN65 to 150 (Fig 5)

Size	N	65	80	100	125	150	
	V		80	100	125	150	200
Torque Nm			80	80	80	100	100

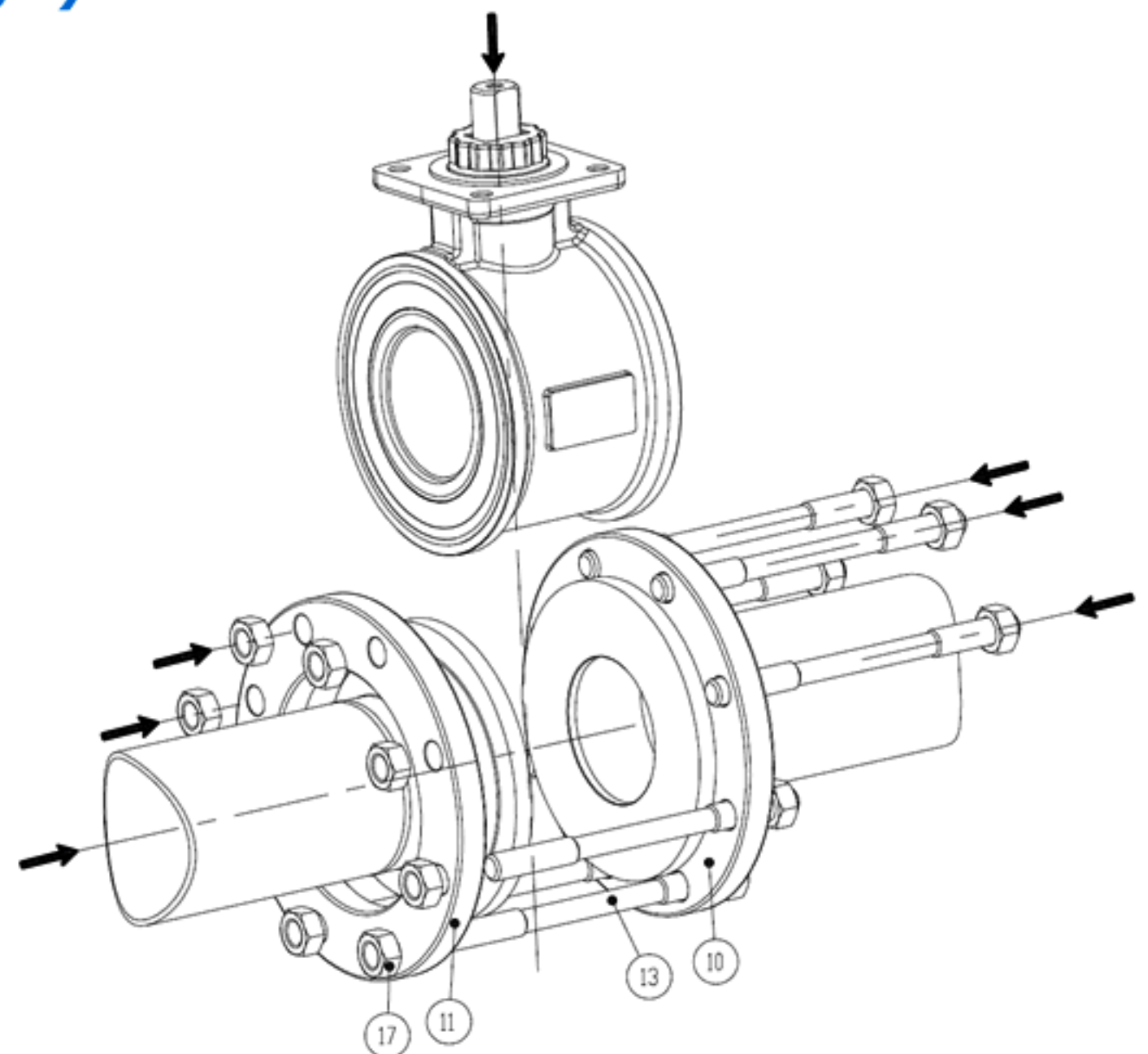

Fig 5

1. Insert body flanges (11) into the pipe
2. Weld the ends (10) on pipe
3. Insert screws (13), spacers (12) and nuts in the body flanges (11)
NOTE to keep some screws apart in order to further allow valve body positioning
4. Insert the valve body between ends (ball should be in the open position)
5. Put on the last screws (13), and nuts (17)
6. Orientate the valve body as required around the pipe and tighten screws (13) and nuts (17) according to the following torque values